

### ELECTRICAL SCOPE OF WORK

- DISCONNECT AND REMOVE THE ELECTRICAL SPACE HEATERS AND PATCH THE WALL.
- REMOVE THE CIRCUIT BREAKERS FROM THE PANEL THAT FED THE EXISTING SPACE HEATERS. INSTALL BLANKS IN UNUSED CIRCUIT BREAKER SPACES.
- FURNISH & INSTALL ONE (1) NEW CIRCUIT BREAKERS IN EACH PANEL TO FEED THE NEW MINI-SPLIT AIR HANDLING UNITS AND CONDENSER UNIT AS FOLLOWS:
  - ONE BEDROOM - CU, 2-POLE 25A
- FURNISH AND INSTALL 1/2" EMT CONDUIT AND (2) #10 AWG, CU & (1) #10 AWG, CU GROUND FROM THE EXISTING PANEL TO THE CU.
- FURNISH & INSTALL A 30A, 2-POLE, NON-FUSED DISCONNECT SWITCH FOR THE CU. THE DISCONNECT SWITCH FOR THE CU SHALL BE NEMA 3R RATED. INDOOR UNITS ARE POWERED FROM THE EXTERIOR UNIT.

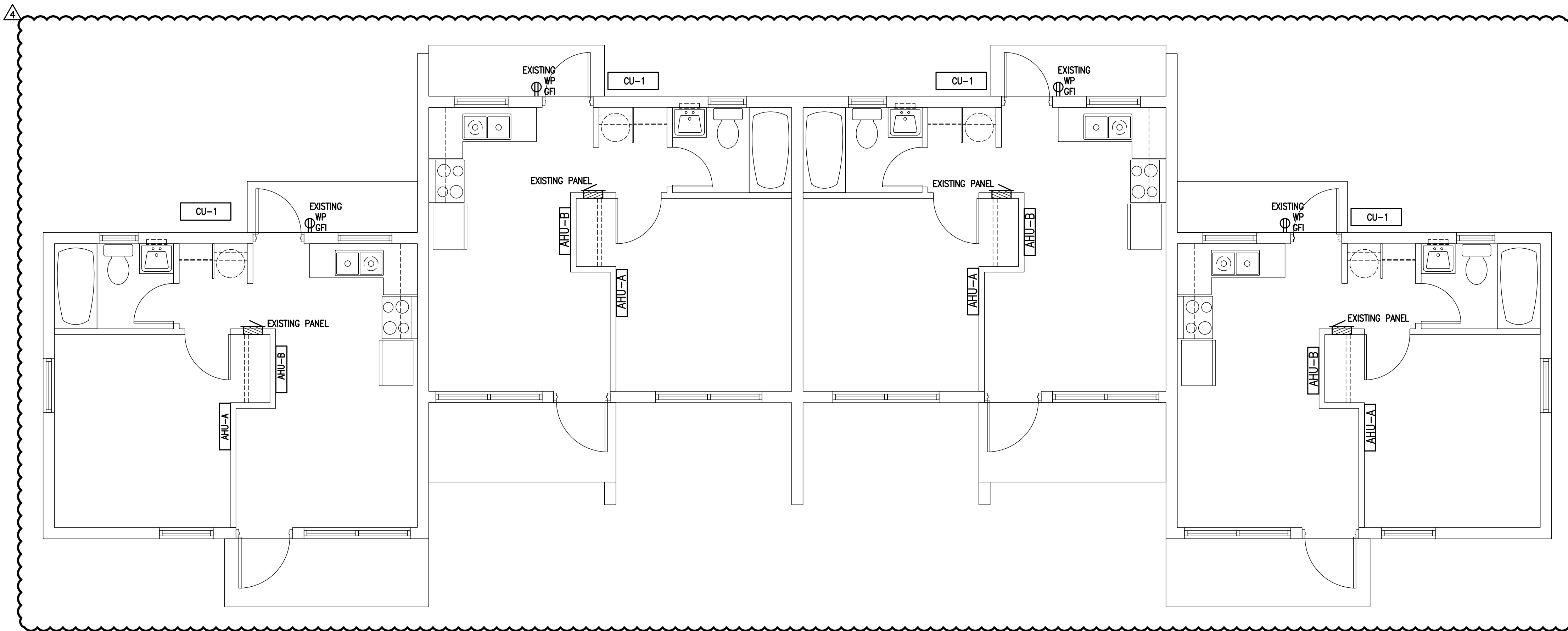

### SECTION A - QUADPLEX MECHANICAL PLAN

SCALE: 1/4" = 1'-0"

### SERVICE ENTRANCE SIZE CALCULATIONS

#### UNIT DATA:

THE DWELLING UNIT HAS AN AREA OF THE FOLLOWING:  
 DWELLING UNIT FLOOR AREA: 408 SQ-FT  
 UNIT HAS AN ELECTRIC RANGE  
 THE LARGER LOAD OF ELECTRIC HEAT OR A/C IS USED FOR THE CALCULATIONS  
 THERE WILL BE NO LAUNDRY FACILITIES IN THE DWELLING

#### LOAD CALCULATIONS:

##### GENERAL LOAD

GENERAL LIGHTING LOAD	AT 3.0 VA / SQ-FT	1,224.0 VA
SMALL APPLIANCE LOAD (2 CIRCUITS)		3,000.0 VA
ELECTRIC RANGE		8,000.0 VA
ELECTRIC WATER HEATER		3,600.0 VA
<b>TOTAL GENERAL LOAD</b>		<b>11,600.0 VA</b>

APPLICATION OF DEMAND FACTOR:		
FIRST 10,000 VA @ 100%		10,000.0 VA
REMAINDER OF LOAD AT 40%		640.0 VA
<b>GENERAL LOAD WITH DEMAND FACTOR</b>		<b>10,640.0 VA</b>

##### AIR CONDITIONING/HEATING LOAD

HEATING / (FUTURE) A/C LOAD		4,320.0 VA
<b>HVAC LOAD</b>		<b>4,320.0 VA</b>

GENERAL LOAD WITH DEMAND FACTOR	10,640.0 VA
HVAC LOAD	4,320.0 VA
<b>TOTAL DWELLING LOAD</b>	<b>14,960.0 VA</b>

62.3 A @ 120/240V 1-PHASE

SERVICE SIZE FOR EACH DWELLING UNIT: 100A

### EXISTING QUADPLEX PANEL SCHEDULE - SECTION A

COLLIER COUNTY HOUSING AUTHORITY  
 IMMOKALEE / COLLIER COUNTY, FLORIDA

PANEL RATING: 100A  
 VOLTAGE: 120 / 240  
 NUMBER OF PHASES: 1  
 SERVICE ENTRANCE RATED: NO

MOUNTING: RECESS  
 MAIN BREAKER RATING: MLO  
 GROUND STRAP REQ'D: NO  
 MANUFACTURER: AS SPECIFIED

NO	A	P	NOTE	DESCRIPTION	WATTS	kw-L1	kw-L2	WATTS	DESCRIPTION	NOTE	P	A	NO
1	50	2		RANGE	6000	7.500		1500	KITCHEN RECEPTACLES	GFCI	1	20	2
3					6000		7.500	1500	KITCHEN RECEPTACLES	GFCI	1	20	4
5	15	1		LIGHTS	1000	1.180		180	BATHROOM	GFCI	1	20	6
7	20	2		WATER HEATER	1500		2.700	1200	GENERAL PURPOSE RECEPTACLES	AFC	1	20	8
9					1500	3.000		1500	GENERAL PURPOSE RECEPTACLES	AFC	1	20	10
11	20	2		SPACE HEATER	1920			1920	SPACE HEATER		2	20	12
13					1920			1920					14
15	20	1		REFRIGERATOR	1500			360	EXTERIOR RECEPTACLES	GFCI	1	20	16

SEE LOAD CALCULATIONS ON THIS SHEET

THIS ITEM HAS BEEN ELECTRONICALLY SIGNED AND SEALED BY STEVEN R. STAFFORD ON THE DATE INDICATED USING A DIGITAL SIGNATURE. PRINTED COPIES OF THIS DOCUMENT ARE NOT CONSIDERED SIGNED AND SEALED AND THE SIGNATURE MUST BE VERIFIED ON ANY ELECTRONIC COPIES.

PROJECT NAME:  
**Farm Worker Village**  
**Collier County Housing Authority**  
 1800 Farm Worker Way  
 Immokalee, Florida 34142

THIS DESIGN AND THE DRAWINGS THEREOF, PREPARED FOR THIS PROJECT, ARE THE PROPERTY OF THE ENGINEER, STAFFORD ENGINEERING, INC. AND THE DESIGN AND/OR DRAWINGS MAY NOT BE USED IN WHOLE OR IN PART FOR ANY OTHER PROJECT FOR WHICH THE DESIGN AND/OR DRAWINGS WERE PREPARED, WITHOUT THE WRITTEN PERMISSION OF THE ENGINEER, STAFFORD ENGINEERING, INC. NO BUILDING PERMITS SHALL BE ISSUED BY ANY BUILDING DEPARTMENT WITHOUT THE SIGNATURE AND SEAL OF THE ENGINEER.

**STAFFORD ENGINEERING, INC.**  
 3525 Bonita Beach Rd., Suite 110, Bonita Springs, FL 34134  
 239-948-5941 / 239-948-5980 FAX  
 Steven R. Stafford - PE - Florida License # 34664  
 Certificate Of Authorization No. 26464

#	REVISION	DATE
4	OWNER CHANGES	JUNE 26, 2020

DATE: 09/14/16  
 DRAWN BY: R.A.M.  
 CHECKED BY: S.R.S.  
 JOB NUMBER: 16079

E-1